

Twister light

Electromechanical tripod turnstile



The ideal solution for selecting pedestrian access in high flow areas, also with transponder card control

- Twister light is the innovative turnstile for selecting transit in high flow areas.
- Made from stainless steel, it is ideal for railways stations and ports, underground stations, sporting facilities and anywhere where it is essential to control pedestrian flows, optimising entry and exit operations.
- Twister light is the resistant and functional solution, suitable for all transit control and selection requirements.
- It can be installed anywhere, even where there are extremely high flows such as in stadiums, stations, underground stations, public offices and sports centres.
- Controlled by a built-in control panel, Twister light is perfectly compatible with all the latest access control systems.

Dimensions (mm)

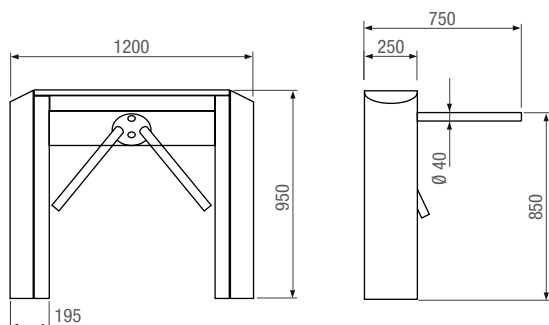

Application (mm)

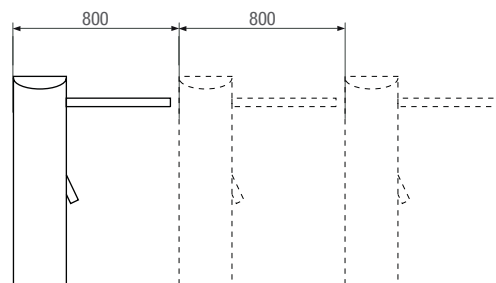

Technical information

Type	PSBPS07N - PSBPS08
Protection rating IP	44
Power supply (V)	230 AC
Operating power supply (V)	24 DC
Current draw (mA)	500
Weight (Kg/lb)	60/132.27
Operating temperature (°C/°F)	-20 ÷ +55 / -4 ÷ +131

● 230 V AC

The full range



CAME

Code	Description	Price € (VAT not included)
------	-------------	----------------------------

Electromechanical tripod turnstiles

001 PSBPS07N	AISI 304 steel two-way electromechanical turnstile with scotch-brite finish, complete with control panel and hydraulic damper. Automatic tripod release in the event of a blackout.	
---------------------	--	--



Accessories for electromechanical tripod turnstiles

001 PSOPSC01	Anti-panic arms with articulated pressure joint.	
---------------------	--	--



001 PSOPG01	AISI 304 steel channeller complete with post with arc, galvanised iron fixing flange and chrome-plated plastic flange cover. H = 1,000 mm / H = 39.37 in .	
--------------------	--	--



001 PSOPG01X	AISI 304 steel channeller complete with post with arc, fixing flange and flange cover. H = 1,000 mm / H = 39.37 in .	
---------------------	--	--



001 PSOPCN03	Electronic counter.	
---------------------	---------------------	--



001 PSOPSF03	Two-way high luminosity LED traffic light.	
---------------------	--	--