

Flag

Mechanical swing turnstiles



The multi-purpose solution for controlling pedestrian flows

- Flag is the mechanical swing turnstile which you push to open and which is closed automatically by gravity.
- It can be used in many different environments: swimming pools, sports centres, fitness/wellness centres, retail outlets, emergency exits, shopping centres and supermarkets.
- It is designed to aid access for disabled people.
- Flag is ideal wherever you need to control the direction in which people move, for safety, control and hygiene reasons.
- It is perfect if used as a service access in retail outlets and as an opening used as an emergency exit.

Dimensions (mm)

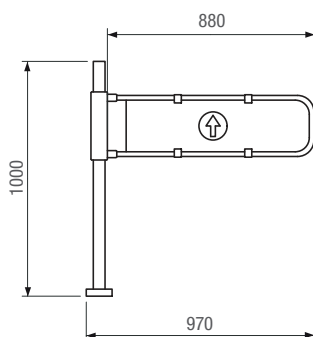

Application (mm)

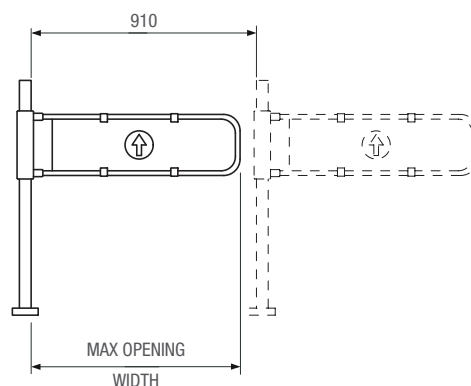

Technical information

Type	001PSBPCWOA - 001PSBPCCWA - 001PSBP00A
Weight (Kg/lb)	10 / 22.04

The full range



Code	Description
Mechanical swing turnstiles	
001 PSBPCWOA	Mechanical swing turnstile with right-hand post and lock with key. H = 1,000 mm L = 900 mm / H = 39.37 in L = 35.43 in.
001 PSBPCCWA	Mechanical swing turnstile with left-hand post and lock with key. H = 1,000 mm L = 900 mm / H = 39.37 in L = 35.43 in.
001 PSBP00A	Two-way mechanical swing turnstile with lock with key H = 1,000 mm L = 900 mm / H = 39.37 in L = 35.43 in.
Accessories	
001 PSOPG01	AISI 304 channeller complete with post with steel arc, galvanised iron fixing flange and chrome-plated plastic flange cover H = 1,000 mm/ H = 139.37 in.
001 PSOPG01X	AISI 304 steel channeller complete with post with arc, fixing flange and flange cover H = 1,000 mm/ H = 139.37 in.
Customisation	
001 PSMLANT01	Supplement to change leaf length. (MIN = 500 mm - MAX = 900 mm / MIN = 19.68 in - MAX = 35.43 in).

